



2002 CHESTNUT AVENUE WILMETTE



2002 CHESTNUT AVENUE · WILMETTE

@properties | CHRISTIE'S
INTERNATIONAL REAL ESTATE

LP LUXURY
PORTFOLIO
INTERNATIONAL



JESSICA COURI BROKER

773.520.6111 mobile
847.881.0200 office
jessicacouri@atproperties.com



JESSICA COURI

2002 CHESTNUT AVENUE • WILMETTE





2002 CHESTNUT AVENUE 4 BED 3 FULL BATH

FEATURES

- Curb appeal on beautiful Chestnut Ave. with extra wide lot at 65 x 175
- Spacious foyer and hallways
- Southern exposure offering an abundance of light throughout the house
- Three gas starter fireplaces
- Custom built in bar with drink cooler drawers
- Kitchen offers custom cabinets/coffee bar area
- Wolf 6 burner stove, Sub Zero refrigerator, Bosch dishwasher
- Private office on first floor
- Large 4th bedroom on first floor with a full bath close by
- Plantation shutters in primary bedroom as well as 2nd bathroom
- Primary bathroom includes a steam shower/double sinks
- Blue stone porch and walkway
- Landscaped front and backyard with lighting



JESSICA COURI BROKER

773.520.6111 mobile
847.881.0200 office

jessicacouri@atproperties.com



JESSICA COURI































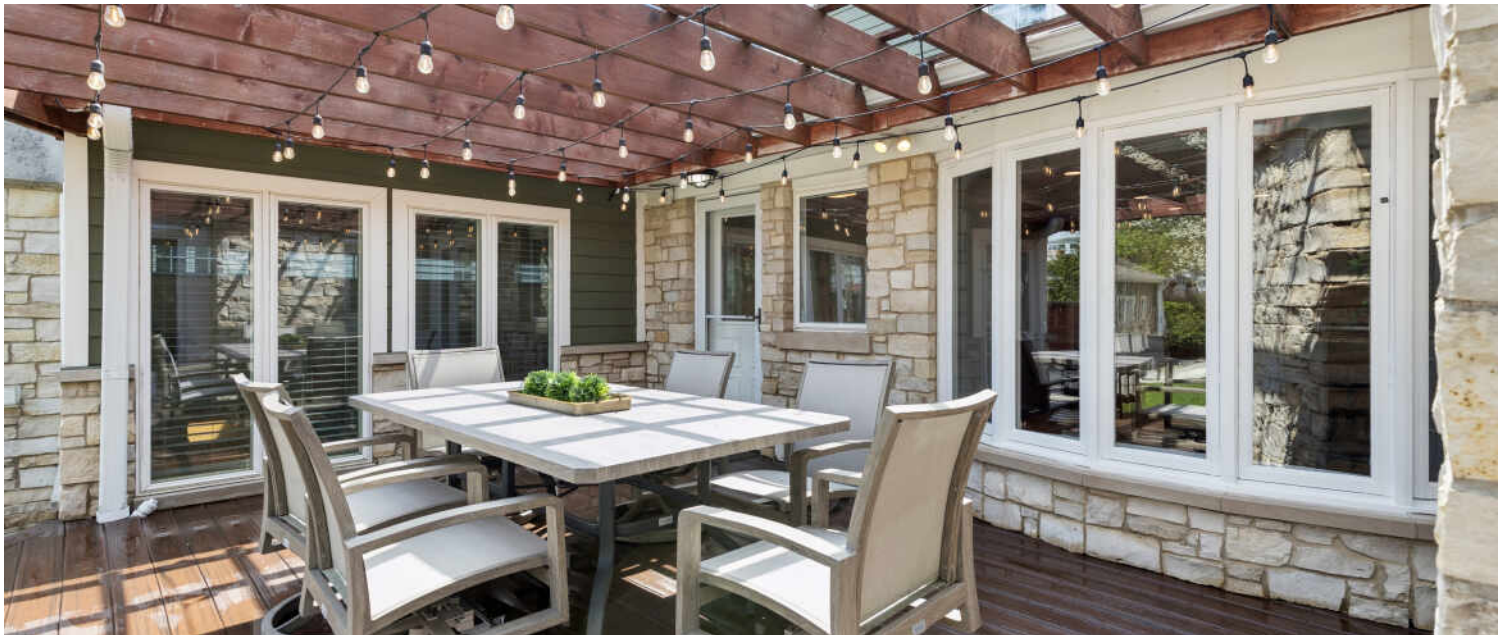



RANKED BY *CHICAGO* MAGAZINE AS ONE OF THE CHICAGO AREA'S BEST PLACES TO LIVE, **WILMETTE** IS A VIBRANT TOWN WITH A WEALTH OF AMENITIES.

Locals love the convenience that comes with living in this picturesque North Shore community. From shopping and fine dining to a beautiful lakefront setting that's within easy reach of downtown Chicago, Wilmette has it all.

When it comes to housing, there's no shortage of architectural styles and price points in this lakefront community. Quintessential Cape Cod, Victorian, and Colonial homes line the village's historic streets, many of which are paved with clay-fired bricks from the 1800s. In addition to single-family homes, there are beachfront condominiums and townhomes. While well-kept homes maintain Wilmette's rich architectural history in all of its glory, new construction attests to the village's enduring popularity.

Residents also have access to nationally recognized New Trier High School, located in Winnetka.

Wilmette's Metra station and access to I-94 make commuting to downtown Chicago a breeze, but there's plenty of reasons to stay local. At the heart of town is the Village Center, where you'll find specialty stores, restaurants, and the Wilmette Theatre. Along Sheridan Road there is Plaza del Lago, providing more shops and services to locals. Meanwhile, ample recreational activities are available at Gillson Park and beach, Wilmette Harbor, and the Centennial Recreation Complex, which includes swimming, tennis, and ice skating.



SCALE AND DIMENSIONS ARE APPROXIMATE, ACTUAL MAY VARY



SCALE AND DIMENSIONS ARE APPROXIMATE, ACTUAL MAY VARY

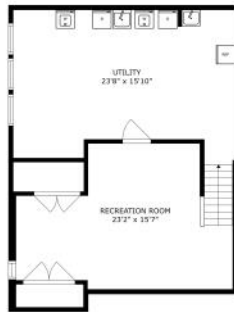

SCALE AND DIMENSIONS ARE APPROXIMATE, ACTUAL MAY VARY



