

2500 THAYER STREET  
EVANSTON





#### ROOM DIMENSIONS

LIVING ROOM : 19' x 16'

DINING ROOM : 16' x 11'

FAMILY ROOM : 13' x 12'

PRIMARY BEDROOM : 15' x 13'

SECOND BEDROOM : 14' x 11'

DEN : 38' x 15'

This incredibly charming home is deceiving...so much space, so much character - truly a rare find. Situated on a block that has one of (if not the) longest running block parties in Evanston, 2500 Thayer welcomes you from the screened front porch and beyond. The proper living room with a bay window and wood burning fireplace leads to the charming dining room. Built-ins and crown molding throughout both rooms - the architectural detail truly enhances each room. The dining room leads to both the eat-in kitchen but also has French doors to the second floor or first floor spaces (family room/bath/bedroom). For those looking for main level living - there are two generous rooms plus a full bath and built-in storage. Upstairs you will find a large open space plus three bedrooms and an office (or small bedroom), full bathroom and endless potential for those wanting to renovate. The basement is unfinished but dry and has laundry, a walk out stairway, great project space or future possibilities. A newer rear deck with room for a table overlooks the carefully planned perennial landscaping and wildflowers surrounding the home for seasonal enjoyment. Gardeners will appreciate the corner lot. Enjoy this practical home with its vintage detail (including a 1955 Chambers stove) as it is, or renovate it for unlimited potential. Regardless, this is a special home looking for its next longtime owner.



4 BEDROOM  
2 BATH







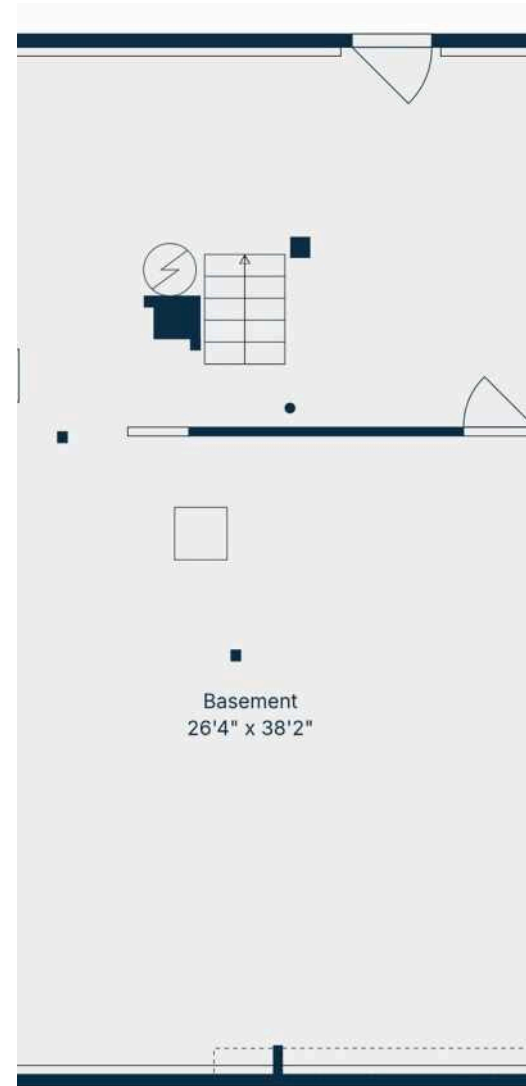

**TOTAL: 2030 sq. ft**

Basement 1: 0 sq. ft, 1st floor: 1140 sq. ft, 2nd floor: 890 sq. ft, Deck: 182 sq. ft, Foyer: 11 sq. ft, LOW CEILING: 63 sq. ft, WALLS: 241 sq. ft

Plan Created By Cubicasa App. Measurements Deemed Highly Reliable But Not Guaranteed.



**TOTAL: 2030 sq. ft**

Basement 1: 0 sq. ft, 1st floor: 1140 sq. ft, 2nd floor: 890 sq. ft, Deck: 182 sq. ft, Foyer: 11 sq. ft, LOW CEILING: 63 sq. ft, WALLS: 241 sq. ft

Plan Created By Cubicasa App. Measurements Deemed Highly Reliable But Not Guaranteed.



**TOTAL: 2030 sq. ft**

Basement 1: 0 sq. ft, 1st floor: 1140 sq. ft, 2nd floor: 890 sq. ft, Deck: 182 sq. ft, Foyer: 11 sq. ft, LOW CEILING: 63 sq. ft, WALLS: 241 sq. ft

Plan Created By Cubicasa App. Measurements Deemed Highly Reliable But Not Guaranteed.



## NESTLED ALONG THE SHORES OF LAKE MICHIGAN, **EVANSTON** BLENDS NATURAL BEAUTY WITH VIBRANT CITY LIVING.

Known for its historic homes, tree-lined streets, and scenic beaches, it's a community full of character and charm.

Home to prestigious Northwestern University, Evanston offers a rich mix of culture, education, and entertainment – from Big Ten sports and academic events to art galleries, theaters, and music.

The lively downtown features bookstores, boutiques, restaurants, and cafes that attract both locals and visitors. Outdoor lovers can explore miles of parks, nature trails, and public beaches.

Evanston offers a wide range of housing options – from grand lakefront mansions and classic single-family homes to modern townhomes and high-rise condos near shops and transit.

With easy access to downtown Chicago via CTA trains, buses, Pace routes, and three Metra stations, Evanston is a connected, convenient, and inspiring place to call home.

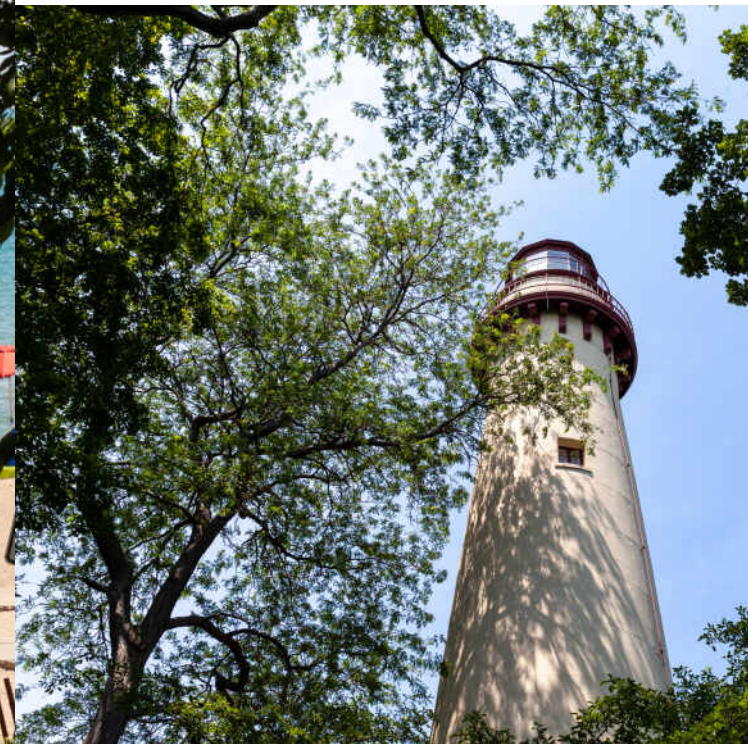

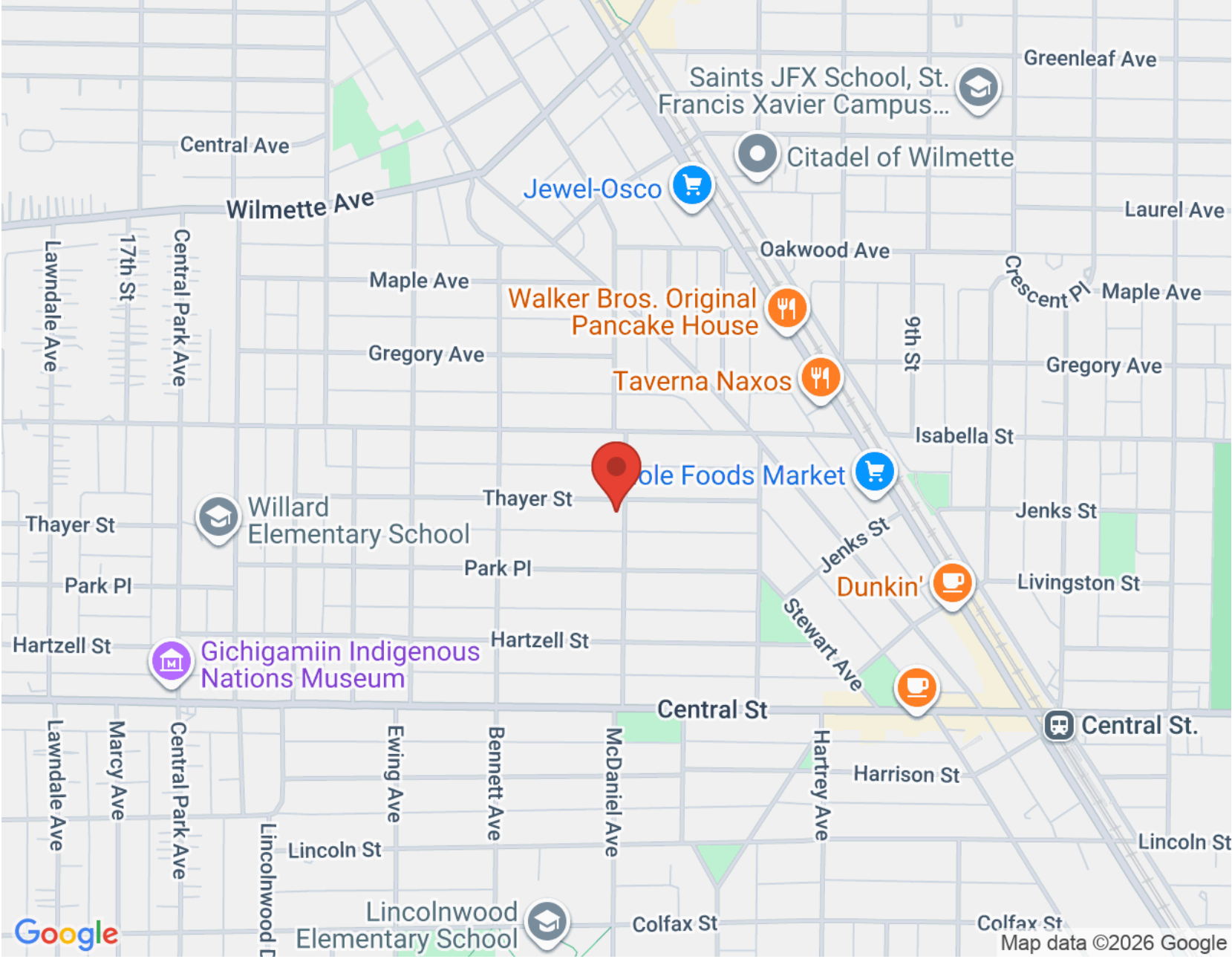

NOTES \_\_\_\_\_

\_\_\_\_\_

\_\_\_\_\_

\_\_\_\_\_

\_\_\_\_\_

\_\_\_\_\_

\_\_\_\_\_

\_\_\_\_\_

\_\_\_\_\_

\_\_\_\_\_

\_\_\_\_\_



## MEREDITH SCHREIBER

1 8478286622

8477630200

MEREDITH@ATPROPERTIES.COM

WWW.NORTHSHORECHICAGO.COM