



66666 95TH AVENUE
BIG CROOKED LAKE

66666 95TH AVENUE · BIG CROOKED LAKE



@properties | CHRISTIE'S
INTERNATIONAL REAL ESTATE

LP LUXURY
PORTFOLIO
INTERNATIONAL



DOUG WORTMAN ASSOCIATE BROKER

269.930.2250 mobile
dougwortman@atproperties.com
www.WortmanGroup.com

WORTMAN
GROUP

66666 95TH AVENUE • BIG CROOKED LAKE





66666 95TH AVENUE RARE LAKEFRONT OPPORTUNITY WITH 144' OF FRONTAGE

FEATURES

Rare Lakefront Opportunity on Big Crooked Lake, this is lake living at its finest! Welcome to an incredible property on highly sought-after Big Crooked Lake featuring 144 feet of sandy bottom frontage on a spacious .77-acre lot. From the moment you arrive, you'll feel it — life really is better at the lake. Enjoy a generous, level yard to the lake perfect for games and gatherings, a pier, and your own boat launch for easy days on the water.

The home is full of character and charm, with an abundance of windows that frame breathtaking views of the lake. Inside you'll find on the main level, a large living room with a cozy fireplace, formal dining area, 3 bedrooms and a full bath. Upper level with 2 additional bedrooms plus extra sleeping space — this home is designed to comfortably sleep up to 25 people. The walkout lower level offers another full bath, laundry, a 1-car garage, and tons of storage for all your lake toys.

You'll also appreciate the detached 2-car pole barn and plenty of parking for guests. Additional peace-of-mind features include a whole-house generator, a newer roof (2023), and HVAC system (2017). Big Crooked Lake is a beautiful 110-acre all-sports lake in the desirable Sister Lakes area of Dowagiac. Southwest Michigan's lifestyle is hard to beat — award-winning golf courses, wineries, breweries, and snowmobile trails all nearby. This is a true lakefront gem that doesn't come along often. If you've been dreaming of owning your own slice of Big Crooked Lake, now is the time.



DOUG WORTMAN ASSOCIATE BROKER

269.930.2250 mobile

dougwortman@atproperties.com
www.WortmanGroup.com

WORTMAN
GROUP























































Total: 3756 sq. ft

Basement: 1298 sq. Ft, 1st Floor: 1588 sq. Ft, 2nd Floor: 870 sq. ft

Excluded Areas: Storage: 174 sq. Ft, Walls: 251 sq. ft

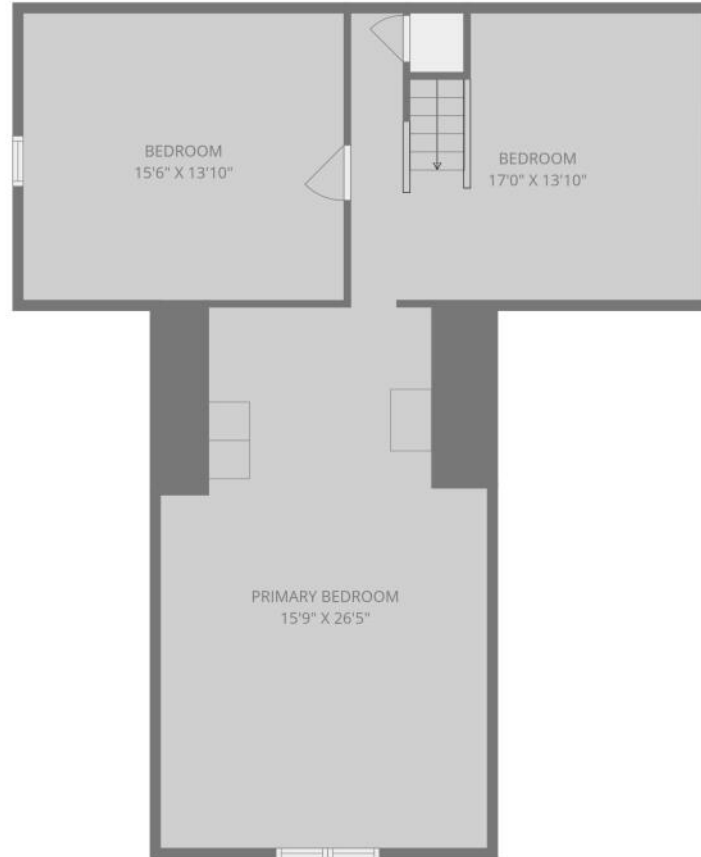

Total: 3756 sq. ft
Basement: 1298 sq. Ft, 1st Floor: 1588 sq. Ft, 2nd Floor: 870 sq. ft
Excluded Areas: Storage: 174 sq. Ft, Walls: 251 sq. ft



Total: 3756 sq. ft

Basement: 1298 sq. Ft, 1st Floor: 1588 sq. Ft, 2nd Floor: 870 sq. ft
Excluded Areas: Storage: 174 sq. Ft, Walls: 251 sq. ft







@properties® | CHRISTIE'S
INTERNATIONAL REAL ESTATE

Leading REAL ESTATE
COMPANIES
OF THE WORLD®

LP
LUXURY
PORTFOLIO
INTERNATIONAL

