

# 900 N LAKE SHORE DRIVE #1706

ARCHITECT MIES VAN DER ROHE'S LEGACY ON LAKE SHORE DRIVE



@properties®

CHRISTIE'S  
INTERNATIONAL REAL ESTATE

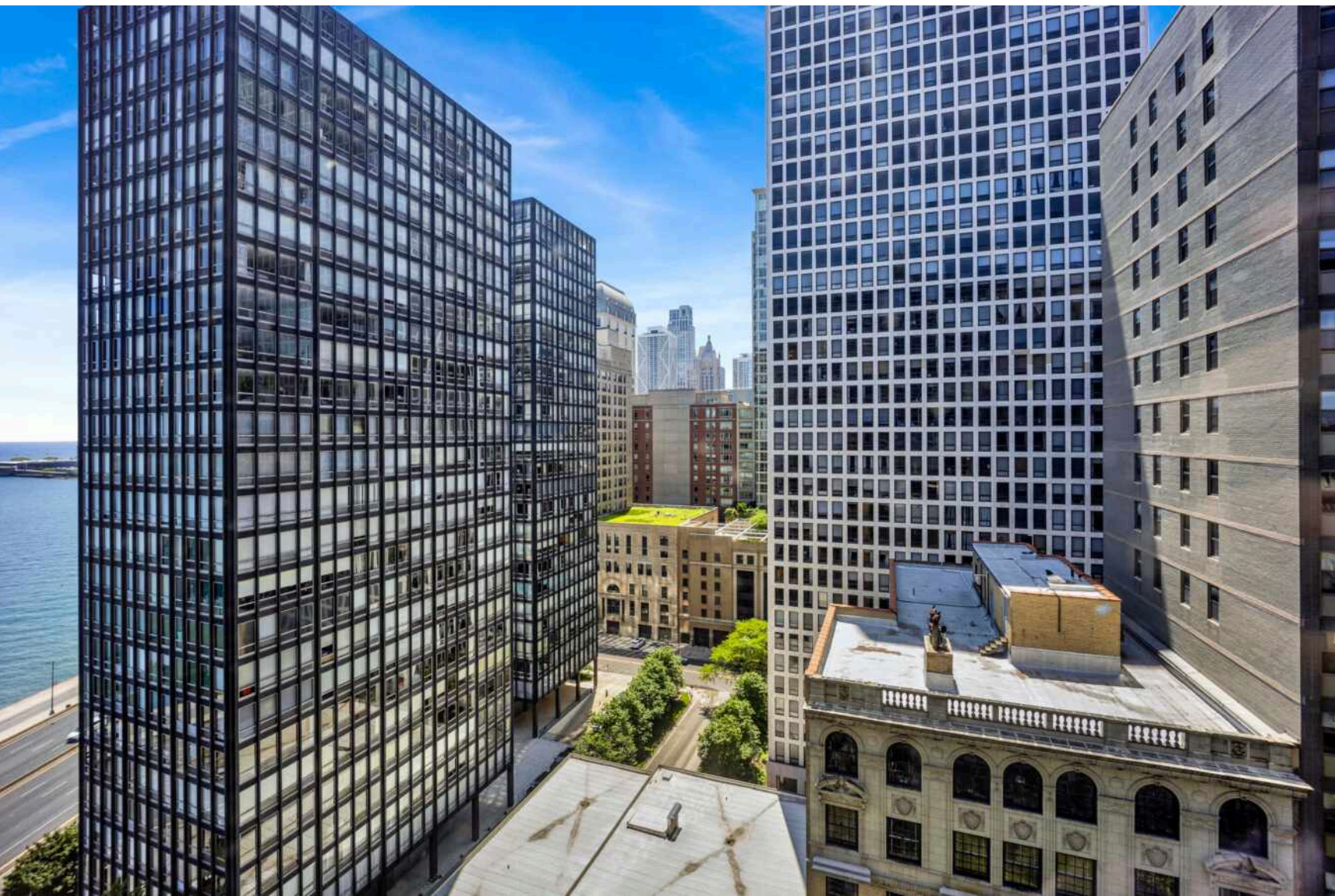

## HEART OF STREETERVILLE

Spacious and airy, this large one bedroom condo offers a sunny south exposure with stunning city views and even a peak of gorgeous Lake Michigan, less than a block away. Conveniently located in the beautiful and urbane Streeterville neighborhood along Chicago's lakefront, this A+ location is certain to please. This is in the largest one-bedroom tier in the iconic 900 Lake Shore Drive Apartments by world-renowned architect Mies van der Rohe. Enjoy this spacious floor plan that features an expansive living room with a separate dining area. The kitchen features the retro and highly sought-after Republic Steel kitchen cabinets. Brand new laminate wood floors throughout and a refreshed bathroom with a new vanity add to the appeal. Life is a breeze in this full-amenity building with 24-hour door staff and maintenance, commissary, sundeck, receiving room, valet dry cleaning service, tailor, bike storage, and storage locker. Welcome Home!

World-renowned architect Mies van der Rohe fully established his career in Chicago after emigrating from Germany, where he served as a director at the ground-breaking Bauhaus school of architecture and design in the pre-World War II era. Establishing himself in Chicago, he built a practice that resulted in a number of Chicago commissions, including the buildings at 900-910 N Lake Shore Drive. A master of proportions and a proponent of "less is more", the timeless nature of his architecture continues to place Mies as one of the world's pre-eminent 20th century architects.



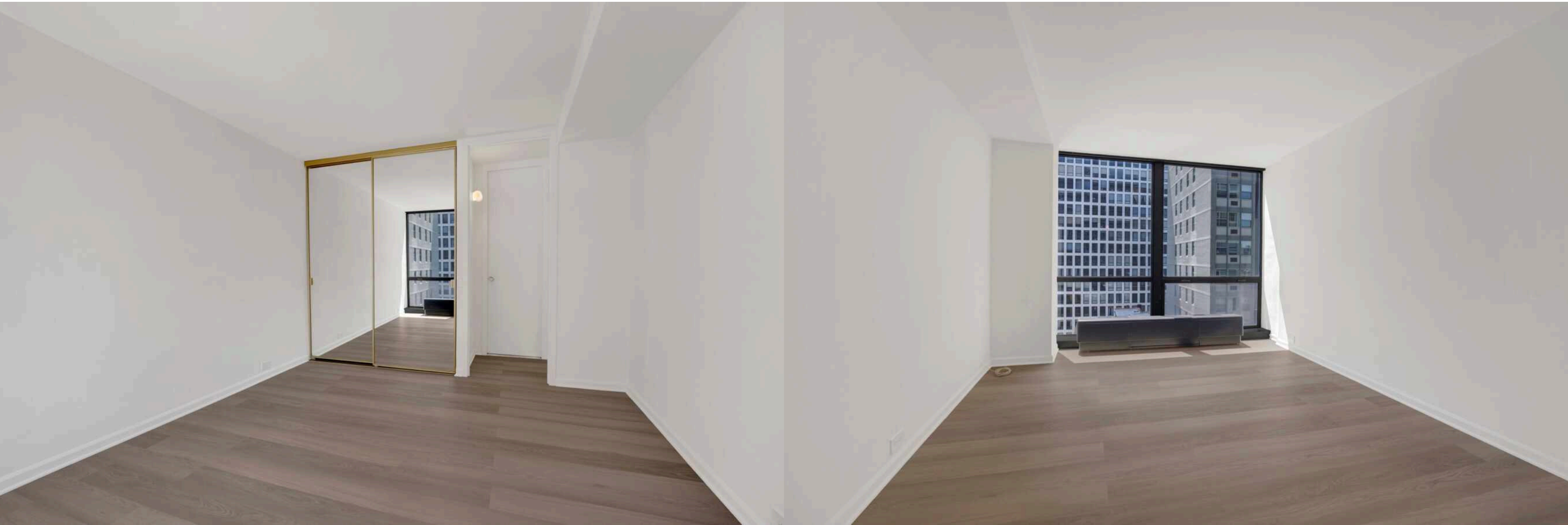

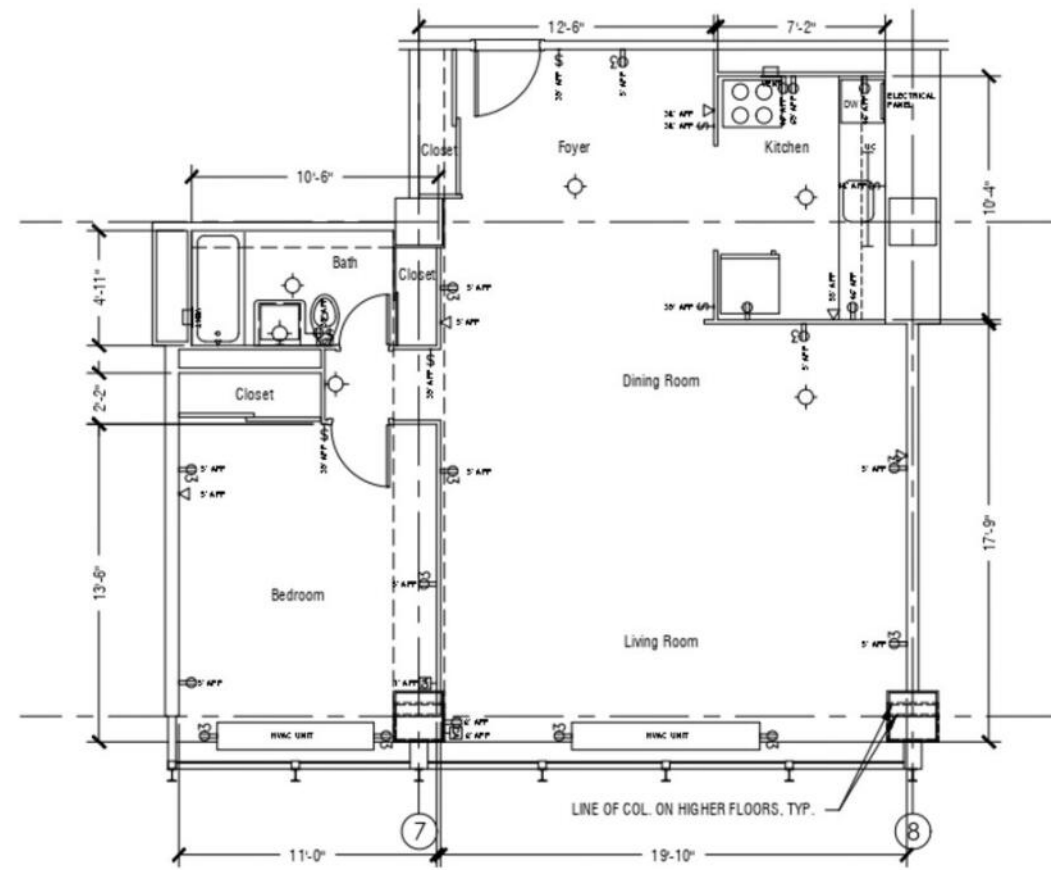





## CAROLINE MOELLERING

(312) 320-9550

CAROLINEMOELLERING@ATPROPERTIES.COM

A PASSION FOR ARCHITECTURALLY SIGNIFICANT HOMES

CAROLINE MOELLERING

MIES-*perize*

@properties®

CHRISTIE'S  
INTERNATIONAL REAL ESTATE